

**CONSTRUCTION ATELIER DE FABRICATION
ET DE STOCKAGE : PIECE DE RECHANGES
FABRIQUES MOTOTRI-CYCLE**

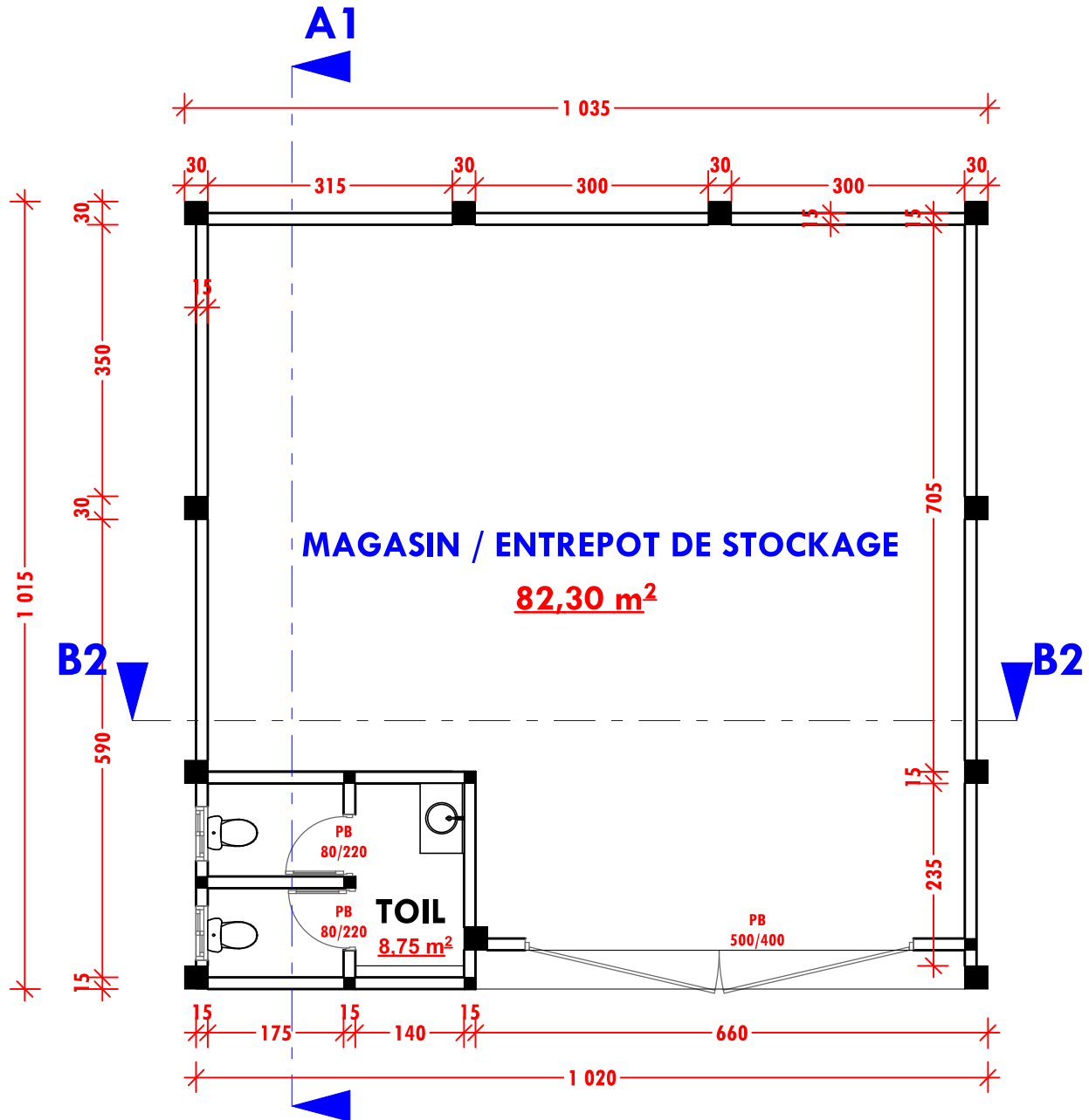

**CONSTRUCTION ATELIER DE FABRICATION
ET DE STOCKAGE : PIERCE DE RECHANGES
FABRIQUES MOTOTRI-CYCLE**

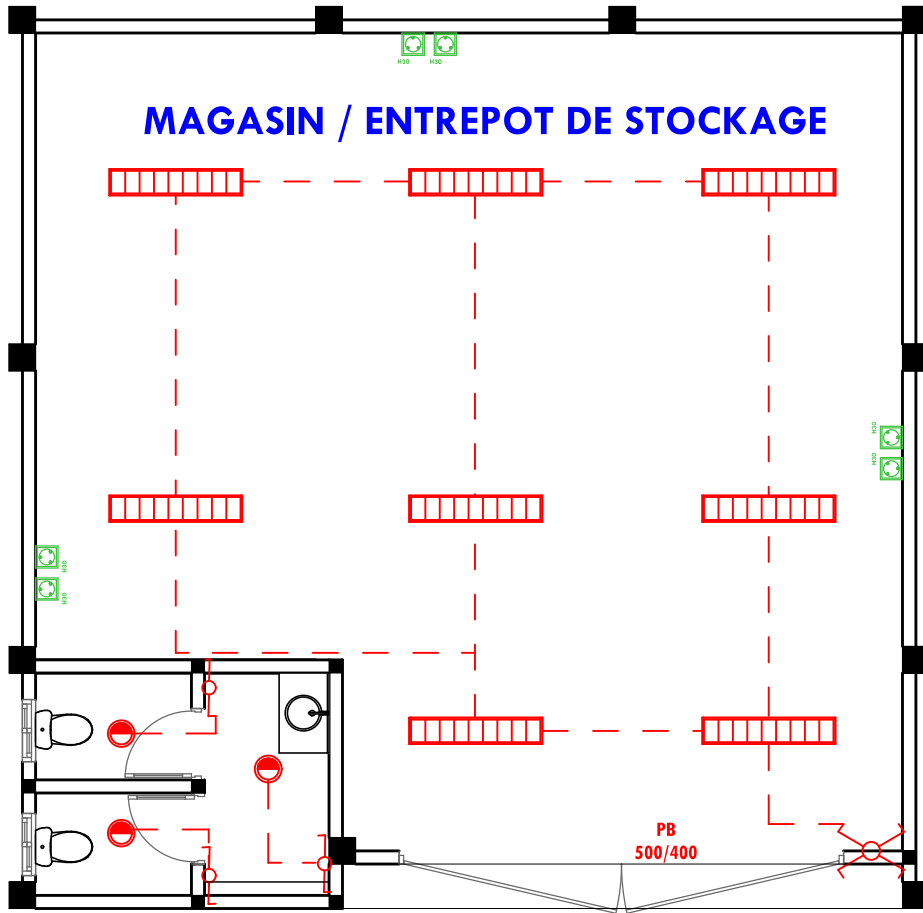

**CONSTRUCTION ATELIER DE FABRICATION
ET DE STOCKAGE : PIECE DE RECHANGES
FABRIQUES MOTOTRICYCLE**

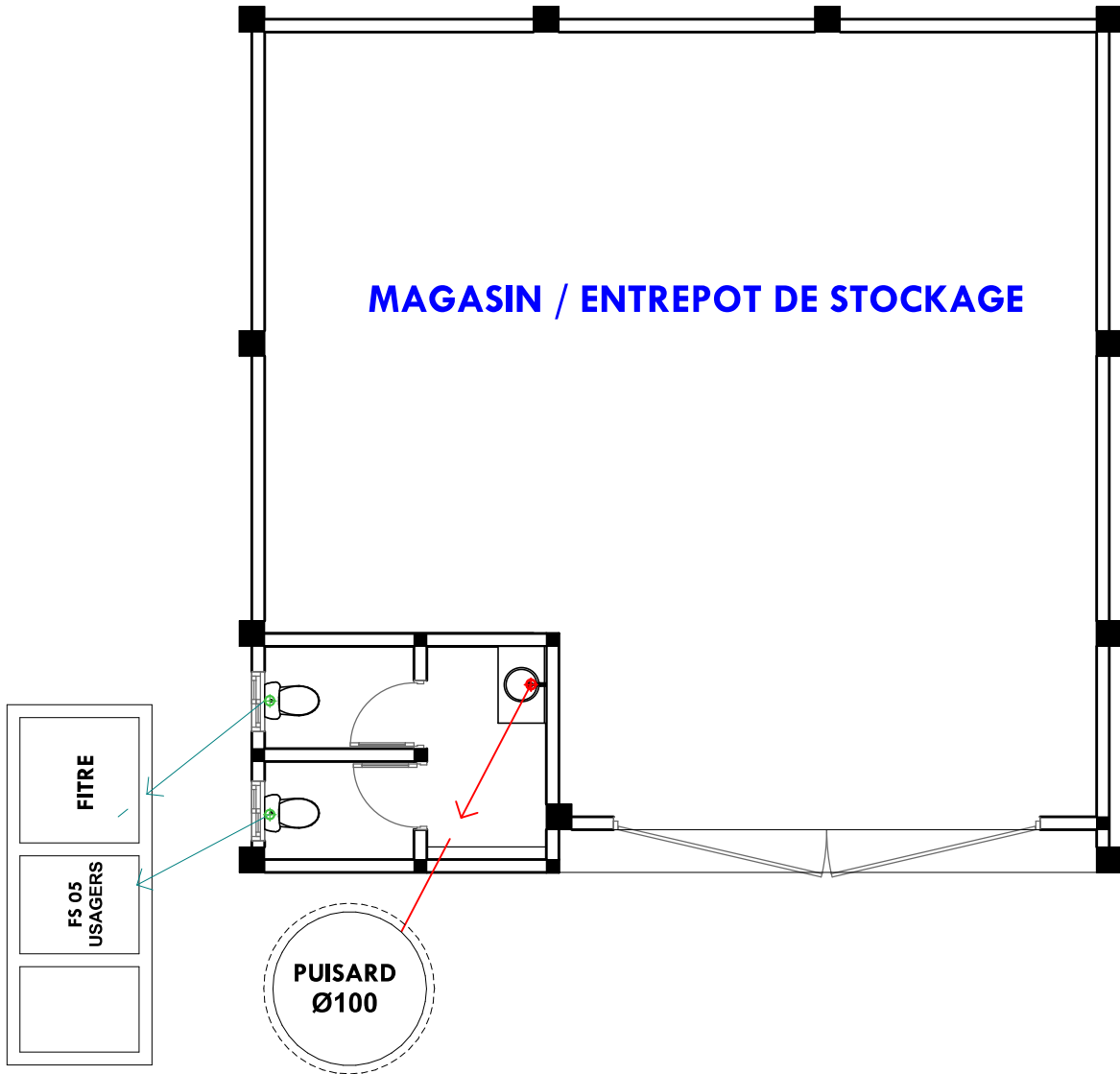

**CONSTRUCTION ATELIER DE FABRICATION
ET DE STOCKAGE : PIECE DE RECHANGES
FABRIQUES MOTOTRICYCLE**

